

SKYPATH

AUCKLAND HARBOUR BRIDGE PATHWAY TRUST

10 years of campaigning for walking and cycling access
on the Auckland Harbour Bridge



1959

Auckland's Harbour Bridge opens. Over 100,000 people walk across before the bridge is open to traffic only.

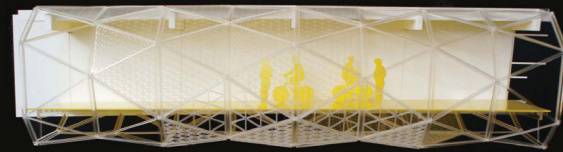

Transit responds to Parliament's Select Committee that strengthening works on the AHB's clip-ons will include provision for walking and cycling access.

NZTA advise that walking and cycling access on the AHB is not possible and refuse to investigate any further.

A public demonstration of support is organised by the GetAcross campaign. Over 5,000 Aucklanders march across the bridge on 30 May 2009.

NZTA agrees to permit SkyPath as a "community facility", but confirms it won't fund the facility. The Transport Committee sets up a Steering Group to discuss the Pathway proposal.

Auckland Transport commissions Ernst & Young to review SkyPath's business plan. The Public Infrastructure Partnership (PIP) Fund makes an offer to 100% fund SkyPath.

Auckland Council's Transport Committee supports SkyPath and sends to Strategy and Finance.

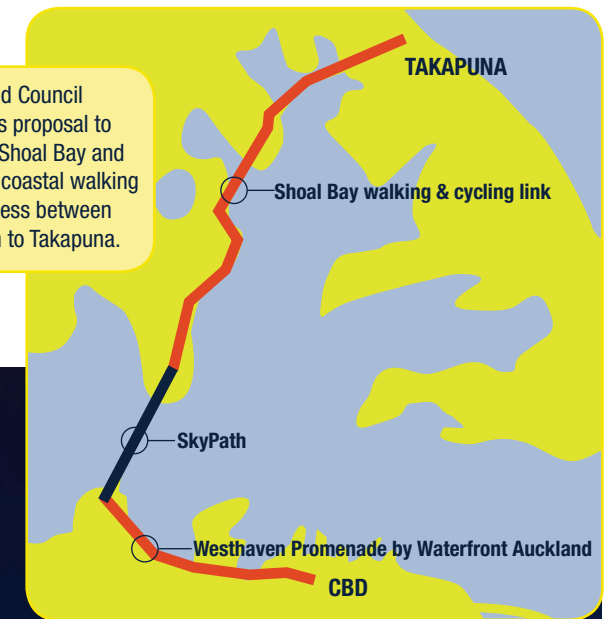

2003

2004

2005

2006

2007

2008

2009

2010

2011

2012

2013

2014

Petition presented to Parliament's Transport & Industrial Relations Select Committee, who request Transit (now NZTA) carry out a feasibility study into walking & cycling access on the Auckland Harbour Bridge.

Transit undertake a major strengthening project of the AHB clip-ons and commit to future proofing for walking & cycling access.

NZTA refuses to allow a public walk across the AHB on its 50th anniversary because it would be 'too popular to permit'.

NZTA agrees to review the SkyPath concept. NZTA and consultants Beca work with the Pathway Trust.

NZTA adopts SkyPath as its preferred option for walking and cycling across the Waitemata as part of the next Harbour Crossing. NZTA recognises that the SkyPath can be integrated with plans for walking and cycling for an additional Waitemata Harbour Crossing.

Petition to Parliament organised by Cycle Action Auckland's Graeme Knowles and Isy Kennedy. 6,700 signatures are gathered in support of walking and cycling access on the Auckland Harbour Bridge.



getacross.org.nz

GetAcross campaign launched and sign up over 11,000 supporters

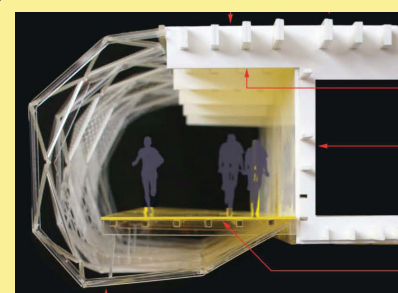

The SkyPath concept is initiated by AHB Pathway Trust, a group of community leaders and professionals, including engineers, architects and transport planners, working on a volunteer basis.

Mayor Len Brown makes SkyPath one of his priorities for the new Auckland "SuperCity".



The SkyPath Concept Design is launched. Aucklanders are asked for their feedback. Mayor Len Brown and MP Nikki Kaye launch the concept design for SkyPath.

